

CE			
IEC EN 60598	IP66		
		RoHS	
220-240V 50Hz			

IK		SCx	Hmax
09	7 kg	0,034 m²	9 m

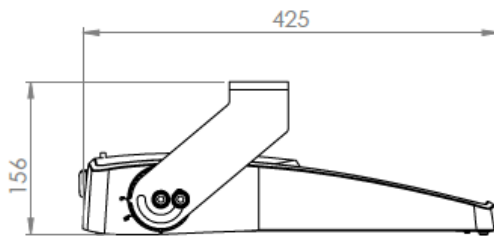

2 fixations sont nécessaires suivant norme EN 60598-2-5
2 fasteners required according to standard EN 60598-2-5

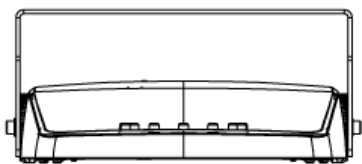
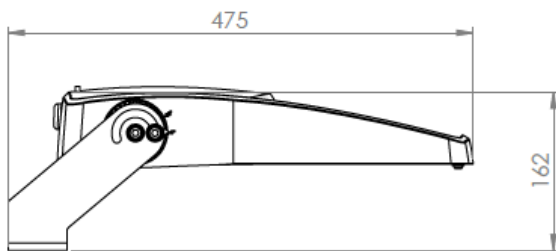
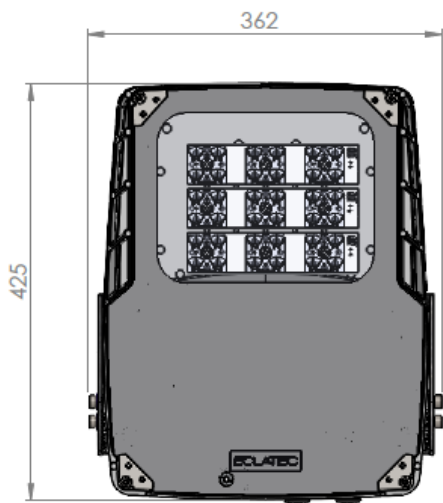
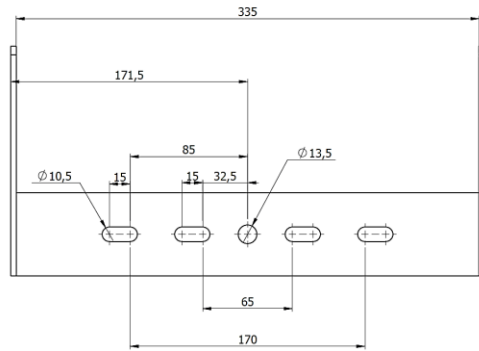
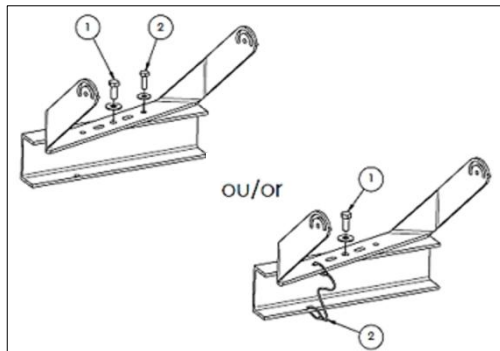

La source lumineuse contenue dans ce luminaire ne doit être remplacée que par le fabricant ou son agent de maintenance ou une personne de qualification équivalente.
The lighting part included in this luminaire must be maintained by the manufacturer, an authorized service agent or a person with similar technical qualification.
La sostituzione della sorgente luminosa contenuta in questo apparecchio deve essere effettuata solo dal produttore o dal suo addetto alla manutenzione o da una persona con qualifiche equivalenti.

1

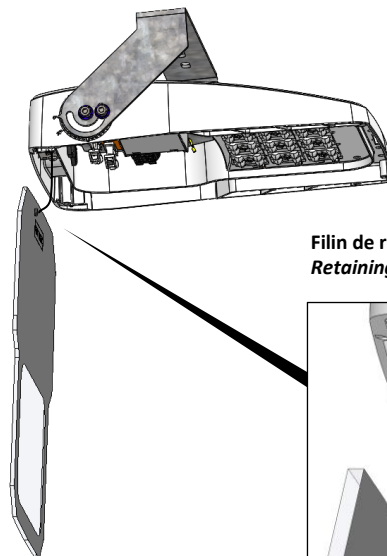
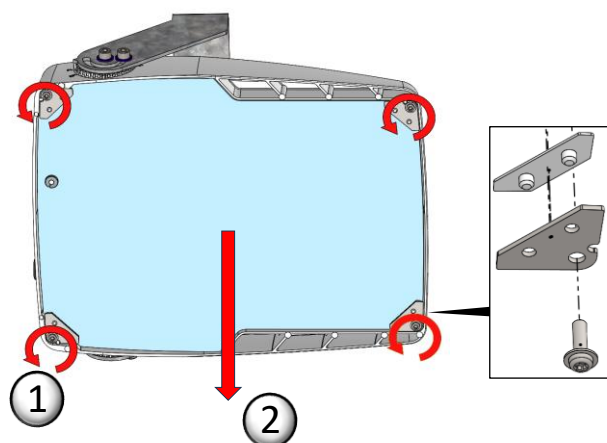

Fil de retenue /
Retaining wire

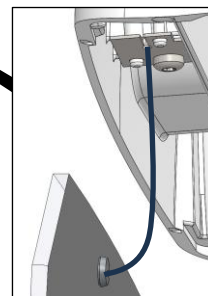

2

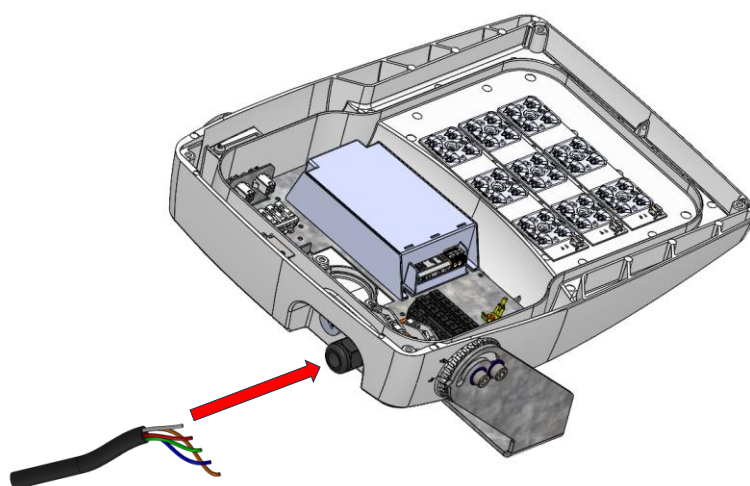

3 A



PH N°1

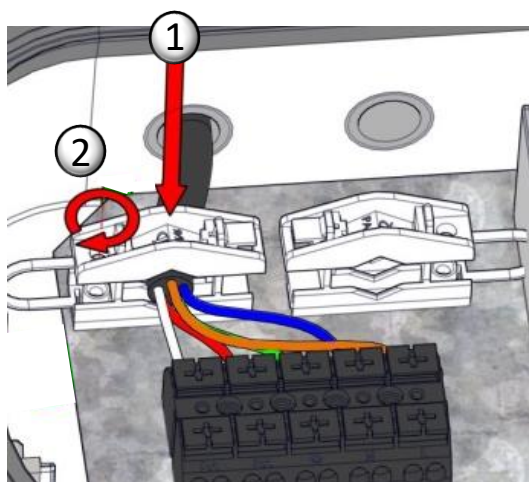

Les fils DALI en pied de poteau doivent être séparés et isolés s'ils ne sont pas connectés.

DALI wires at the bottom of the pole must be separated and isolated if they are not connected.

I cavi DALI alla base del palo devono essere separati e isolati se non sono collegati.

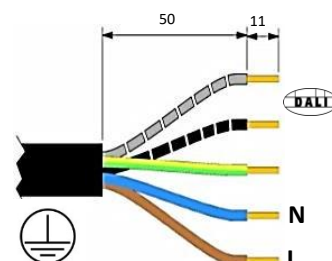
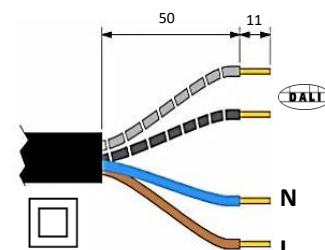

La source lumineuse contenue dans ce luminaire ne doit être remplacée que par le fabricant ou son agent de maintenance ou une personne de qualification équivalente.

The lighting part included in this luminaire must be maintained by the manufacturer, an authorized service agent or a person with similar technical qualification.

La sostituzione della sorgente luminosa contenuta in questo apparecchio deve essere effettuata solo dal produttore o dal suo addetto alla manutenzione o da una persona con qualifiche equivalenti.

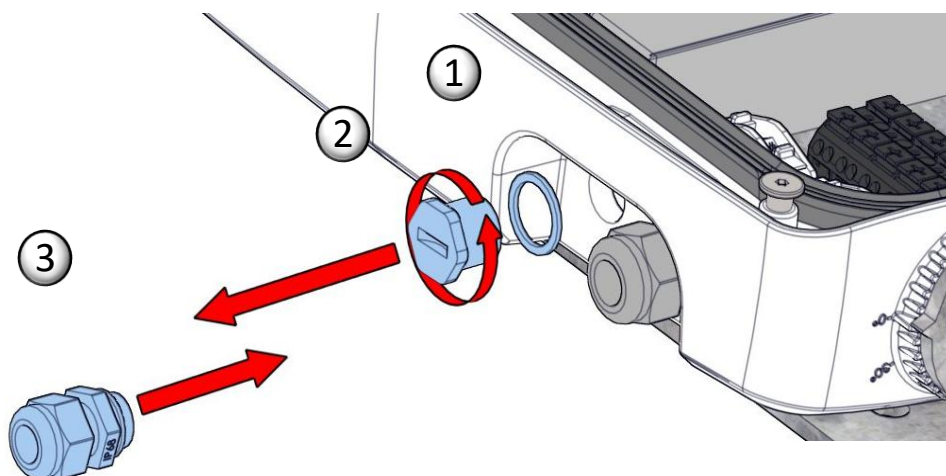

PH N°1

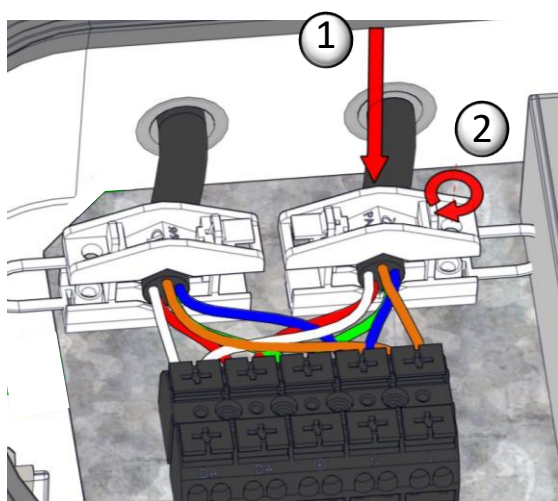

Les fils DALI en pied de poteau doivent être séparés et isolés s'ils ne sont pas connectés.

DALI wires at the bottom of the pole must be separated and isolated if they are not connected.

I cavi DALI alla base del palo devono essere separati e isolati se non sono collegati.

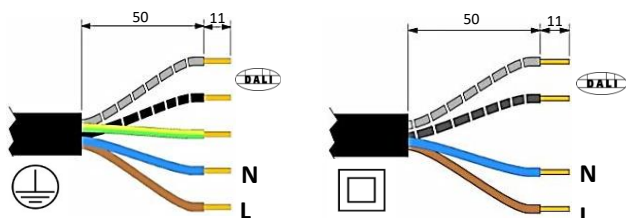

4



x4

4N.m ±1

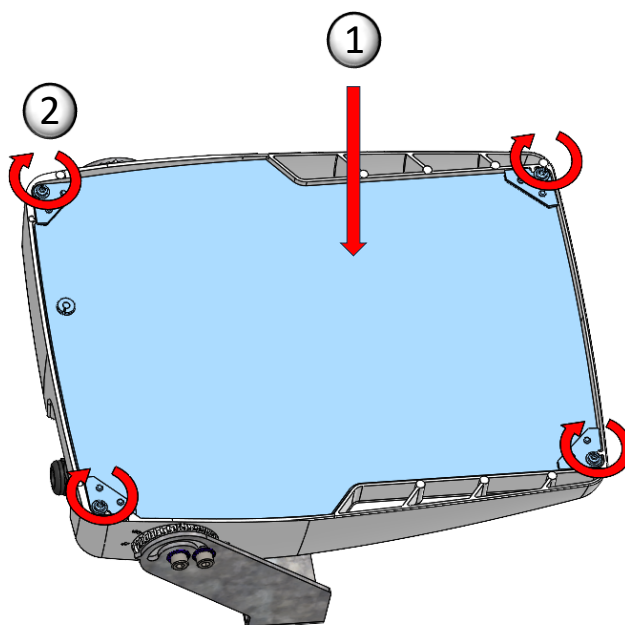

Autres notices



La source lumineuse contenue dans ce luminaire ne doit être remplacée que par le fabricant ou son agent de maintenance ou une personne de qualification équivalente.

The lighting part included in this luminaire must be maintained by the manufacturer, an authorized service agent or a person with similar technical qualification.

La sostituzione della sorgente luminosa contenuta in questo apparecchio deve essere effettuata solo dal produttore o dal suo addetto alla manutenzione o da una persona con qualifica equivalente.

5



6 x4

20N.m ±1

SUSPENDU / Suspended

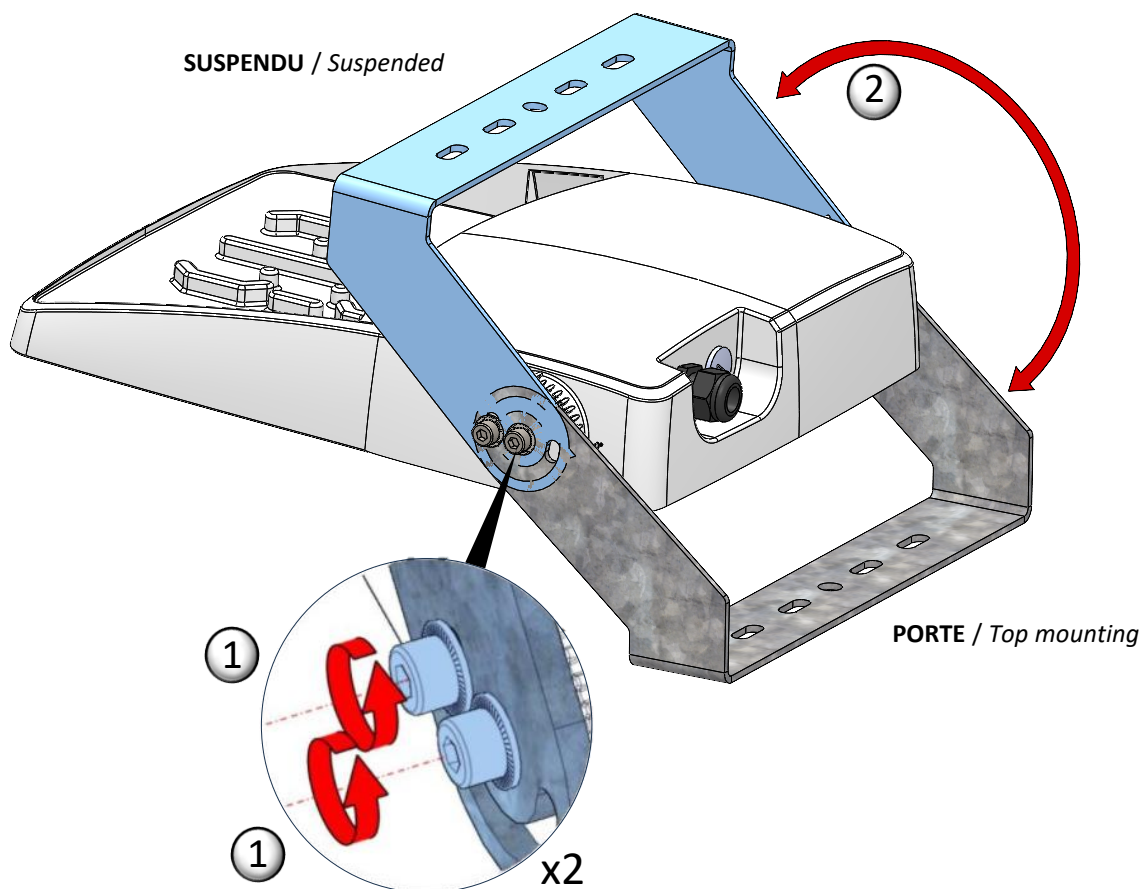

6

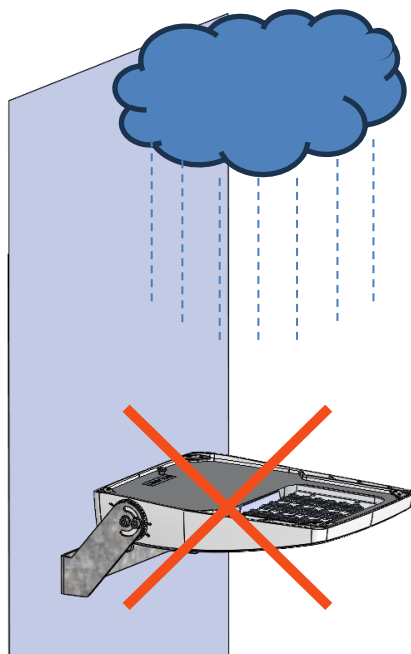

La source lumineuse contenue dans ce luminaire ne doit être remplacée que par le fabricant ou son agent de maintenance ou une personne de qualification équivalente.
 The lighting part included in this luminaire must be maintained by the manufacturer, an authorized service agent or a person with similar technical qualification.
 La sostituzione della sorgente luminosa contenuta in questo apparecchio deve essere effettuata solo dal produttore o dal suo addetto alla manutenzione o da una persona con qualifiche equivalenti.